



Description

Mircom's TX3-CX-2K-A is a powerful hybrid IP and RS-485 networked two door controller that will manage up to 126 doors using the RS-485 network. Use TCP/IP and the system is virtually unlimited. Simply add a TX3-IP module to the panel for TCP/IP networks. The TX3-CX-2K-A Kit comes complete with one TX3-CX controller, two TX3-P300-HA readers, a configurator software on a flash memory stick and a USB cable for programming.

TX3-CX-2-A Door Controller

The TX3-CX-2-A controller has a unique feature of being compatible to the entire family of TX3 platform solutions from voice entry, elevator restriction and wireless Aperio locksets. Unlike other platforms, the TX3 will meet the basic job requirements and accommodate other elements of an intelligent building as the needs arise.

TX3-P300-HA Proximity Reader

The access control kit includes two TX3-P300-HA proximity card readers that deliver exceptional value without compromise on quality, durability, and performance. The TX3-P300-HA proximity card reader comes in an attractive, slim line dark grey enclosure. The reader may be mounted on a metal door frame, a window mullion or directly to an interior or exterior wall or cabinet.

The electronics of the TX3-P300-HA reader are encapsulated in a UL approved epoxy resin potting compound to seal them against adverse environmental conditions. The TX3-P300-HA proximity card readers are metal compensated, resulting in minimal loss of read range and provide ease of installation in various door access applications.

Feature/Benefits

- A hybrid architecture that combines the best of TCP/IP and RS-485. All panels can networked via RS-485 or TCP/IP.
- 8 supervised inputs for a wide selection of monitoring points to be shared between the two card readers
- 8 programmable outputs; 6 are Form C contacts (normally open/normally closed), two provide 12 VDC power for up to 1 amperes of current combined
- Supports all credential formats such as clamshell cards, graphic cards, key tags and wafers (ordered separately)
- Optional vehicular control using dual technology wireless transmitters that can have a built-in proximity coil (wafer)
- Unified database for TX3 voice entry and card access systems reduces administration time and support
- A variety of options to remotely manage the TX3 access panel to fit the site requirements. A modem, a TCP/IP module or use a local USB extender to a PC
- High level features include:
 - High Security
A convenient feature enabling the user to perform 'emergency lock down' or 'emergency evacuation' by swiping an ID card four times in front of a reader to lock or unlock all doors
 - Soft Anti-Pass Back
This function prevents the buddy system by requiring the user to use an exit reader before using an entry reader up to 900 seconds.
 - Mantrap/Interlocking Doors
This feature monitors and controls access to a high value or critical security area by ensuring one door is locked before opening the second door
 - Delayed Egress
This feature requires a user to press and hold a request to exit bar/button before releasing the door enabling security to respond before releasing the door
- Compatible to any Wiegand reader technology including Mifare, biometric, proximity and iClass
- Elevator Control for up to 96 floors to restrict users to specific floors

Access Control Panels



TX3-CX-2K-A Two Door Controller Kit

Comes complete with;

- Two door controller
- Two mullion mount card readers
- System software configurator
- USB cable for connection to PC



TX3-CX-2-A Two Door Controller

A two door controller with system software and a USB cable.

Dimensions:

14" (h) x 12" (w) x 2.8" (d) / 356 mm (h) x 305 mm (w) x 71mm (d)

Readers



SR-2400-GR-MP Mullion Mount Reader

The SR-2400-GR-MP is designed to fit on a 1 3/4" standard metal door or window frame. A metal compensation feature ensures minimal read range loss when the reader is mounted on metal. The readers low profile design esthetically blends to any indoor or outdoor wall surface by two mounting screws.

Voltage: 5 to 12 VDC

Dimension:

4.5 x 1.8 x 0.70 inch (11.4 x 4.5 x 1.8 cm)



TX3-WRR-22

Dual Channel receiver compatible to TX3-WRT-2H two button transmitters.



TX3-P500-HA Single Gang Mount Reader

The TX3-P500-HA is a switch plate reader designed to easily mount directly on a single gang box with a read range of up to 8 inches (20 cm).

Voltage: 5 to 16 VDC

Dimension:

4.6 x 3.1 x 0.36 inch (11.7 x 7.7 x 0.9 cm)

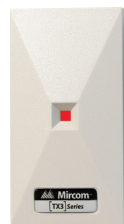
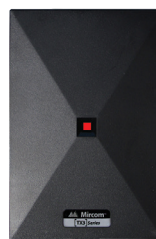

TX3-P300-HA Mini Mullion Mount Reader

The TX3-P300-HA is used for indoor or outdoor applications for up to 6 inch read range.

Voltage: 5 to 16 VDC

Dimension:

3.2 x 1.7 x 0.7 inch (8.0 x 4.3 x 1.7 cm)



TX3-P640-H-A Keypad with Proximity Reader, Single Gang Mount

The TX3-P640-H-A is a combined proximity reader with 12 button keypad designed to fit directly on a single gang box. The TX3-P640-H-A is ideal for dual authentication for high security requirements or where a convenient PIN access would be required.

Voltage: 5 to 16 VDC

Dimension:

4.6 x 3.0 x 0.4inch (11.7 x 7.7 x 1.0 cm)



TX3 Credentials

A full complement of credential styles.

Elevator Restriction

Elevator control is ideal for mixed use buildings where retail and residential access share common elevators. With our TX3-ER-8-A elevator control the user can restrict access to each card holder to specific floor or floors.

The TX3-ER-8-A provides access to one or several floors up to 96 floors or doors, using 2012E relay cards. Typically, a user presents his card to the card reader in the cab, the relays assigned to the card will trip and provide activation to the floor buttons in the elevator cabin and the user can select from the floors he has been granted access to.

TX3-ER-8-A Elevator Restriction Cabinet
2012E Twelve Unit Elevator Restriction Card

PC Requirements

- Dual core processor, 1 GHz
- 1 GB RAM
- 600 MB disk space
- Windows XP SP2/Vista/Windows 7/8, 32 or 64 bit
- USB Connection

TX3 Two Door Controller Wiring

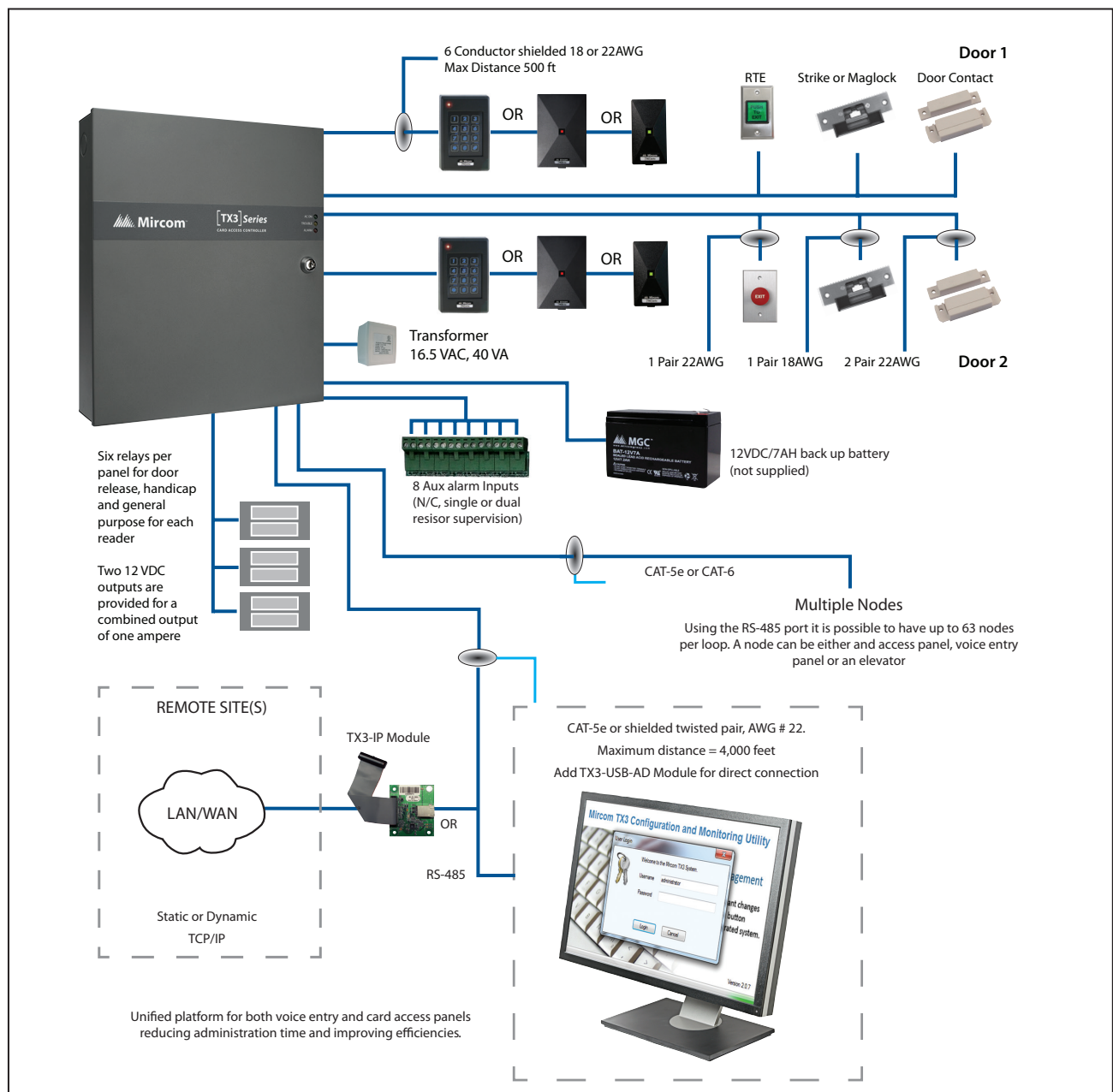

Ordering Information

Model	Description
TX3-CX-2K-A	Two Door Access Control System Kit c/w one TX3-CX Door Controller, two proximity card readers (TX3-P300-HA), transformer, two graphic cards, Configurator software and a USB cable. Battery. For Battery Back-up, add one 12 VDC battery, 5 Ah or 7 Ah.
TX3-CX-2-A	Two Door Controller in a grey metal lockable cabinet including a 16VAC, transformer, software and USB cable. Battery Back-up: Add one 12 VDC battery, 5 Ah to 7 Ah.
Readers	
SR-2400-GR-MP	Mullion Mount Reader, 125 KHz, 5 to 12 VDC. Dimensions: 4.5 x 1.8 x 0.70 inch (11.4 x 4.5 x 1.8 cm)
TX3-P500-HA	Single Gang Mount Reader, Grey, 125 KHz, 5 to 16 VDC, Dimensions: 4.6 x 3.1 x 0.36 inch (11.7 x 7.7 x 0.9 cm)
TX3-P300-HA	Mini Mullion mount, 125 KHz, 5 to 16 VDC, Dimensions: 3.2 x 1.7 x 0.7 inch (8.0 x 4.3 x 1.7 cm)
TX3-P640-H-A	Keypad with Proximity Reader, Single gang mount, 5 to 16 VDC. Dimensions: 4.6 x 3.0 x 0.4 inch (11.7 x 7.7 x 1.0 cm)
39201237	A solid aluminum, tamper resistant, single gang mount keypad, IP68 rated with audible/visual feedback. Operating Temperature: 32°F to 257 °F (-40°C to 125°C)
TX3-WRR-22	Dual Channel Receiver for use with TX3-WRT-2H
TX3-WRR-44	Wiegand Receiver for use with TX3-WRT-4H four button transmitters.
Credentials	
CS-MIR-0-0	Clam Shell Proximity card with slot for portrait orientation strap. Accepts photo ID overlay. Packaged in quantities of 25 pieces.
GR-MIR-H-26 GR-MIR-H-37	Graphics Card for printing on both sides. Provision for portrait or landscape card slot punching. Packaged in quantities of 50 pieces. Available in 26-bit format GR-MIR-H-26 and Mircom format GR-MIR-H-37.
TX3-PDT-H-37	Adhesive proximity disc tag, HID supported, 125 KHz, Mircom format.
PW-MIR-0-0	Proximity Wafer with adhesive backing. One inch (2.54 cm) diameter. Packaged in quantities of 10 pieces.
KT-MIR-0-0	Key tag for key ring. Durable ABS plastic case to withstand years of abuse. Packaged in quantities of 10 pieces.
TX3-WRT-2H	Two Button transmitter with HID supported proximity tag.
TX3-WRT-4H	Four Button transmitter with HID supported proximity tag.
Accessories	
TX3-IP	Add-on TCP/IP Module fits on top of the TX3-CX-2K-A or TX3-CX-2-A motherboard
TX3-MDM	Modem module mounts onto control panel board
TX3-DATA-MDM	Modem USB 2.0 stick, one required per PC. Compliant with V.92, V.90 and V.44
TX3-USB-AD	USB to RS-485 Adaptor kit includes an MD-993 module and mounting hardware
Batteries	
BAT-12V5A	Battery, 12 VDC, 5 AH, one required per TX3-CX Control panel
BAT-12V7A	Battery, 12 VDC, 7.2 AH, one required per TX3-CX Control panel

NOT TO BE USED FOR INSTALLATION PURPOSES.



Canada
25 Interchange Way
Vaughan, Ontario L4K 5W3
Telephone: (905) 660-4655
Fax: (905) 660-4113

U.S.A.
4575 Witmer Industrial Estates
Niagara Falls, NY 14305
Toll Free: (888) 660-4655
Fax Toll Free: (888) 660-4113

Distributed by:

Web page: <http://www.mircomgroup.com> Email: mail@mircomgroup.com

ISO 9001:2008
REGISTERED



CAT. 6545
rev4