

SPEED DOME ACCESSORIES

SPEED DOME MOUNTING ADAPTERS AND CONTROLLERS

MOUNTING ADAPTERS



SD6FTEX
6 Foot Extension Kit

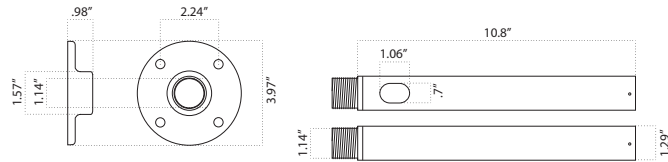

SDICA
Inside Corner Adapter

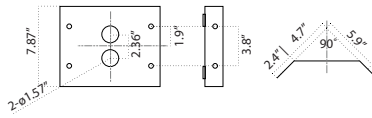

SDPA
Pole Adapter

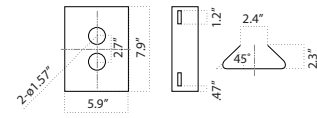

SDOCA
Outside Corner Adapter

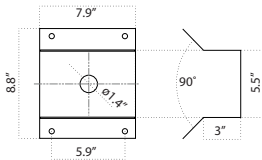

SDPED
Pedestal Adapter

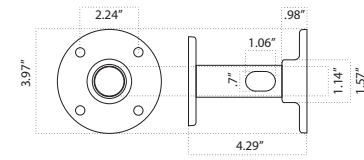

SDRA
Right Angle Adapter

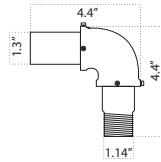

SDADAPTER
Metric to 1.5" NPT Adapter

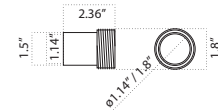

SPEED DOME CONTROLLERS AND SPECIFICATIONS

CONTROLLER SPECIFICATIONS

SDKBD1
Basic Controller



SDKBD2
Full Function Controller



SDKBD3
Full Function Controller w/3-Axis Joystick



	SDKBD1	SDKBD2	SDKBD3
Camera Types	Speed dome cameras		
Camera OSD	Supports all functions		
Lens Control	Supports all functions		
Joystick Control	Pan/Tilt (key controlled zoom)		Pan/Tilt/Zoom
On Screen Display	Supports all functions		
Baud Rates	2400Bps, 4800Bps, 9600Bps, 19200Bps		
Communication	RS-485 Multi-port, Half duplex		
RS-4785 Input	Terminal block, RJ-11 jack		
Effective Range	1200 Meters maximum		
Power Input	12vDC, Power supply included		
Power Consumption	500mA	1A	
Camera Address	Up to 64	Up to 255	
Cameras Supported	Up to 32	Up to 32	
Dimensions (WxDxH)	7.4" x 3.8" x 2.8"	12.4" x 6.5" x 2.3"	

SDKBD1 / SDKBD2 / SDKBD3 Keyboard Controllers Include:

- (1) Manual
- (1) Power Supply
- (1) Screwdriver
- (1) RJ-11 cord (SDKBD2&3 only)

