

HD251

Rugged Fixed Mini-Dome Camera

Quick Installation Guide



Key Features

- 1/3" Interline Transfer CCD image sensor
- 620 TV lines
- Day/night
- Built-in 2.8 – 12 mm DC Vari-focal Auto Iris lens
- 8 Privacy Zones
- Mirror function
- User-friendly design for easy access and adjustment of camera settings
- Vandal-proof and weather-resistant housing; IP66 rating
- 3-D axis gimbal
- Local Video Out port for setup and configuration
- Back Light Compensation
- 12 V DC, 24 V AC power supply
- Quick and easy setup with 6 presets

800-11942V1 – Rev A – 06/2012

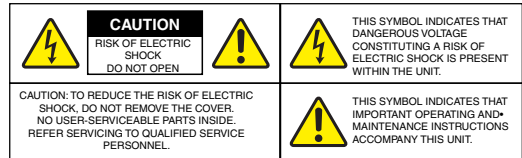

FCC Compliance Statement

Information to the user: This equipment has been tested and found to comply with the limits for a Class A digital device. Pursuant to part 15 of the FCC Rules, these limits are designed to provide reasonable protection against harmful interference when the equipment is operated in a commercial environment. This equipment generates, uses and can radiate radio frequency energy and, if not installed and used in accordance with the instructions, may cause harmful interference to radio communications. Operation of this equipment in a residential area is likely to cause harmful interference in which case the user will be required to correct the interference at his own expense.

CAUTION Changes or modifications not expressly approved by the party responsible for compliance could void the user's authority to operate the equipment.

Canadian Compliance Statement

This Class A digital apparatus complies with Canadian ICES-003.
Cet appareil numérique de la Classe A est conforme à la norme NMB-003 du Canada.

Warranty and Service

Subject to the terms and conditions listed on the Product warranty, during the warranty period Honeywell will repair or replace, at its sole option, free of charge, any defective product returned prepaid.

In the event you have a problem with any Honeywell product, please call Customer Service at 1.800.796.CCTV (North America only) for assistance or to request a Return Merchandise Authorization (RMA) number.

Be sure to have the model number, serial number, and the nature of the problem available for the technical service representative.

Prior authorization must be obtained for all returns, exchanges, or credits. **Items shipped to Honeywell without a clearly identified Return Merchandise Authorization (RMA) number may be refused.**

1. Safety Instructions

BEFORE OPERATING OR INSTALLING THE UNIT, READ AND FOLLOW ALL INSTRUCTIONS.

AFTER INSTALLATION, retain the safety and operating instructions for future reference.

1. **HEED WARNINGS** - Adhere to all warnings on the unit and in the operating instructions.
2. **INSTALLATION**
 - Install in accordance with the manufacturer's instructions.
 - Installation and servicing should be performed only by qualified and experienced technicians to conform to all local codes and to maintain your warranty.
 - Any wall or ceiling mounting of the product should follow the manufacturer's instructions and use a mounting kit approved or recommended by the manufacturer.
3. **POWER SOURCES** - This product should be operated only from the type of power source indicated on the marking label. If you are not sure of the type of power supplied to your facility, consult your product dealer or local power company.

WARNING This device is configured for 12 V DC or 24 V AC operation; do NOT connect to higher voltage. Use only with NRTL-approved class 2 power supplies.

4. **HEAT** - Situate away from items that produce heat or are heat sources such as radiators, heat registers, stoves, or other products (including amplifiers).
5. **MOUNTING SYSTEM** - Use only with a mounting system recommended by the manufacturer, or sold with the product.
6. **ATTACHMENTS** - Do not use attachments not recommended by the product manufacturer as they may result in the risk of fire, electric shock, or injury to persons.
7. **ACCESSORIES** - Only use accessories specified by the manufacturer.
8. **CLEANING** - Do not use liquid cleaners or aerosol cleaners. Use a damp cloth for cleaning.
9. **SERVICING** - Do not attempt to service this unit yourself as opening or removing covers may expose you to dangerous voltage or other hazards. Refer all servicing to qualified service personnel.
10. **REPLACEMENT PARTS** - When replacement parts are required, be sure the service technician has used replacement parts specified by the manufacturer or have the same characteristics as the original part. Unauthorized substitutions may result in fire, electric shock or other hazards.

2. Precautions

Precautions for use

- Read and keep these instructions.
- This camera should be installed by qualified personnel only.
- There are no user-serviceable parts inside. Do not disassemble this camera other than to make the initial adjustments.
- Do not touch the camera lens, dome, or bezel (front glass plate).
- Do not drop the camera or subject it to physical shock.
- Do not use a strong or abrasive detergent when cleaning the camera.
- Use a UL-approved regulated 24 V AC or 12 V DC power supply.
- Use an appropriate low voltage power cable to prevent fire or electrical shock.
- Please ensure that your installation area can support the weight of the camera.

Operating Conditions

- Avoid aiming the camera towards an extreme light source (for example, light fixtures) to prevent damaging the CCD. Do not view direct sunlight with the camera.
- Avoid operating or storing the unit in the following locations:
 - Extremely humid, dusty, hot/cold environments; extreme temperature conditions where the operating temperature is outside the recommended range of 14°F to 122°F (-10°C to 50°C). Be especially careful to provide ventilation when operating under high temperatures.
 - Close to sources of powerful radio or TV transmitters.
 - Near a cooling or heating device.
 - Close to fluorescent lamps or objects reflecting light.
 - Under unstable light sources (may cause flickering).

3. Package Includes

- a HD251 Vandal Dome Camera
- a User Guide
- a Quick Install Guide (this document)
- a Hardware Installation kit (including screws and an Allen key)
- Local Video Output and Power cables

4. Cable Connections

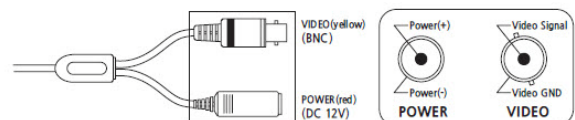

5. Camera Installation

1. Remove the dome from the housing base by loosening the captured screws on the dome.
2. Connect the yellow video output connector to the video input port on your monitor/DVR. Connect the red power connector to your 12 VDC power source. Feed the cables into the hole in the mounting surface (such as a ceiling, see graphic).
3. Install the housing base onto the mounting surface using the three mounting screws provided.
4. Connect the local video output cable to the video output connector on the camera board, located behind the lens and gimbal. Connect the other end of the video connector to the monitor you will use while setting up the camera.

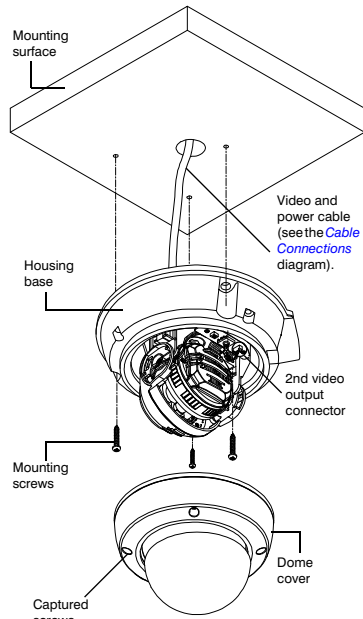

- Note** The video output connector on the camera board is located next to the OSD menu controls that you can use to make configuration changes.
5. While monitoring the camera picture on the monitor, adjust the camera position (orientation), zoom and focus settings (as described in the *Camera Positioning, Zoom and Focus Adjustment* section).
 6. Using the connected monitor, make camera configuration changes through the OSD menus (see the *Configuration Guide* included with your camera for more information).
 7. Re-install the dome cover to the housing base by aligning the captured screws to the screw holes, and then tightening the screws.

6. Camera Positioning, Zoom and Focus Adjustment

1. With the dome removed, you can see that the lens is surrounded by a protective shroud (see the image below).
2. Use two hands to draw back the shroud from the lens by placing both thumbs on the upper front section of the shroud with your fingers bracing the back side of the lens and pushing your thumbs towards your fingers (see the image below).

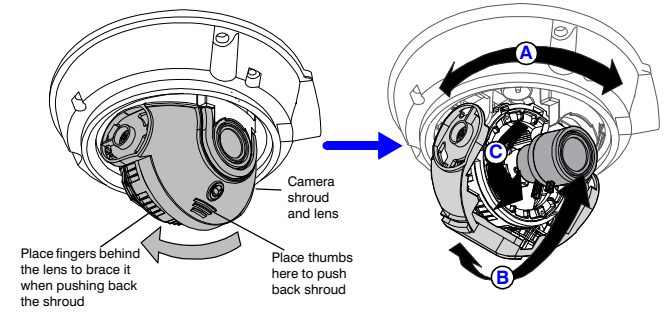

3. Position the camera lens and gimbal so that the camera is viewing the required video scene. Use the connected monitor to check that the field of view is oriented correctly as you make the adjustments. You can pan the entire camera board and gimbal (360°, labelled **A** in graphic above). Tilt the camera lens up and down (90°, labelled **B**), and/or rotate the lens (360°, **C**).
4. Use the three points of adjustment (**A**, **B**, and **C**) to position the camera correctly.
5. Use the two levers located on the lens to adjust zoom and focus, as needed (see the image for zoom and focus lever locations).
6. When the camera is correctly positioned, zoomed and focused, push the shroud back together with the lens.

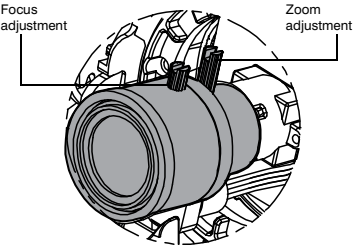

When you push the shroud back together with the lens, this will change the tilt angle that you have set for the lens (adjustment labelled **B**). When the shroud and lens are snapped back together, tilt both pieces back to the desired lens position.

8. Specifications

Video Signal Specifications	
Video Standard	NTSC
Scanning System	2:1 Interlace
Image Sensor	1/3 Interline Transfer CCD
Number of Pixels	768 (H) x 494 (V)
Minimum Illumination	0.3 lux (Color)
Horizontal Resolution	620 TVL
Video Output	1.0 Vp-p, composite @ 75Ohms
Sync System	Internal / Line Lock
S/N Ratio	50dB (AGC Off)
Auto Gain Control	Selectable: OFF, LOW, MID, HIGH
Automatic Electronic Shutter	1/60 - 1/100,000 second
White Balance	ATW, ATC, MANUAL
BLC/HSBLC	Selectable: OFF/ON
Day/Night (SDN or Electronic)	Color, B/W, AUTO, EXT
Lens Type	2.8 - 12 mm Vari-focal Auto Iris
Angle of View	H: 96.7° - 24.1° V: 71.2° - 18.2°
SENS-UP	Auto (x2 ~ x1024)
Mirror Function	OFF/ON (horizontal mirror), selectable
Motion Detection	ON/OFF (4 programmable zones)
Privacy Masking	ON/OFF (8 programmable zones)
D-WDR	ON/OFF (adjustable level)
Sharpness	ON/OFF (adjustable level)
Blemish Compensation	REAL auto
Electrical Specifications	
Input Voltage	Dual Voltage (24 V AC; 12 V DC)
Input Range	12 V DC ± 10%; 24 V DC ± 10%
Mechanical Specifications	
Dimensions	5.9" (150 mm) (W) x 3.9" (100 mm) (H)
Weight	3.1 lbs (1.4 kg)
Construction	Housing: Die-cast Aluminum; Dome: Polycarbonate
Environmental Specifications	
Temperature	Operating: 14°F to 122°F (-10°C to 50°C) Storage: -4°F to 140°F (-20°C to 60°C)
Relative Humidity	0% to 85%, non-condensing
Rating	IP66

Honeywell

www.honeywellvideo.com
+1.800.796.CCTV (North America only)
HVSsupport@honeywell.com

Document 800-11942V1 - Rev A - 06/2012

© 2012 Honeywell International Inc. All rights reserved. No part of this publication may be reproduced by any means without written permission from Honeywell. The information in this publication is believed to be accurate in all respects. However, Honeywell cannot assume responsibility for any consequences resulting from the use thereof. The information contained herein is subject to change without notice. Revisions or new editions to this publication may be issued to incorporate such changes.