

TDN WDR IR Mini Dome Camera

H4W4PRV3

Honeywell's rugged H4W4PRV3 mini dome camera is taking quality and reliability to the next level, offering outstanding picture clarity and hassle-free flexible system integration.

Superior Image Quality

- Full HD 4 MP 20 fps image with a 1/3" 4 megapixel sensor
- Wide Dynamic Range, up to 120 dB, ensures glare-free images
- True Day/Night provides vivid color images by day and clear black-and-white images at night with ICR
- Excellent low-light performance with 3D noise reduction, saving storage and bandwidth

Flexible Surveillance Solution

- 2.8 mm fixed lens at F2.0
- H.264 and MJPEG codec, triple stream support
- IR LEDs provide up to 98 ft (30 m) of illumination in dimly lit or nighttime scenes (depending on scene reflectance)
- Smart IR technology provides even distribution of IR
- Weatherproof (IP66) and vandal-resistant (IK10) camera housing
- -22°F to 140°F (-30°C to 60°C) working temperature
- Plug-and-play compatible with Honeywell 4/8/16-channel Performance Series Embedded NVRs

Easy to Install and Use

- Built-in PoE (Power over Ethernet) eliminates need for separate power supply and associated wiring; 12 VDC inputs where PoE power is unavailable
- Remote configuration through web client or from the NVR
- Compatible with HQA-BB2 junction box, HQA-WK wall mount, HQA-PM pole mount, and HB34S2-CM corner mount



Market Opportunities

These flexible, fully featured cameras are ideal for a wide range of surveillance applications, providing excellent picture quality at minimal bandwidth while offering reliable protection against dust, dirt, and water.

FEATURES AND BENEFITS

- | | | | |
|--|--|---|---|
| <ul style="list-style-type: none">• 1/3" 4 MP progressive scan imager• 2.8 mm fixed lens• True day/night (IR-cut filter)• Wide dynamic range up to 120 dB | <ul style="list-style-type: none">• Low-light performance down to 0.01 lux (color) or 0 lux with IR LEDs on• Up to 100 ft (30 m) IR illumination, depending on scene reflectance• H.264 Main Profile compression | <ul style="list-style-type: none">• Triple stream support• Up to 4 MP resolution at 20 fps• Supports up to 20 connections• Corridor mode• PoE, 12 VDC support | <ul style="list-style-type: none">• Plug-and-play compatible with Honeywell Performance Series Embedded NVRs• IP66 and IK10-rated rugged housing |
|--|--|---|---|

TDN WDR IR Mini Dome Camera

Security Features

The camera can be configured to automatically detect and respond to events such as motion in the scene and/or camera tampering. Automated responses include sending a notification through email, FTP, and/or HTTP, and sending a still image of the event through email and/or FTP. Setup can be done using the web client or from an NVR.

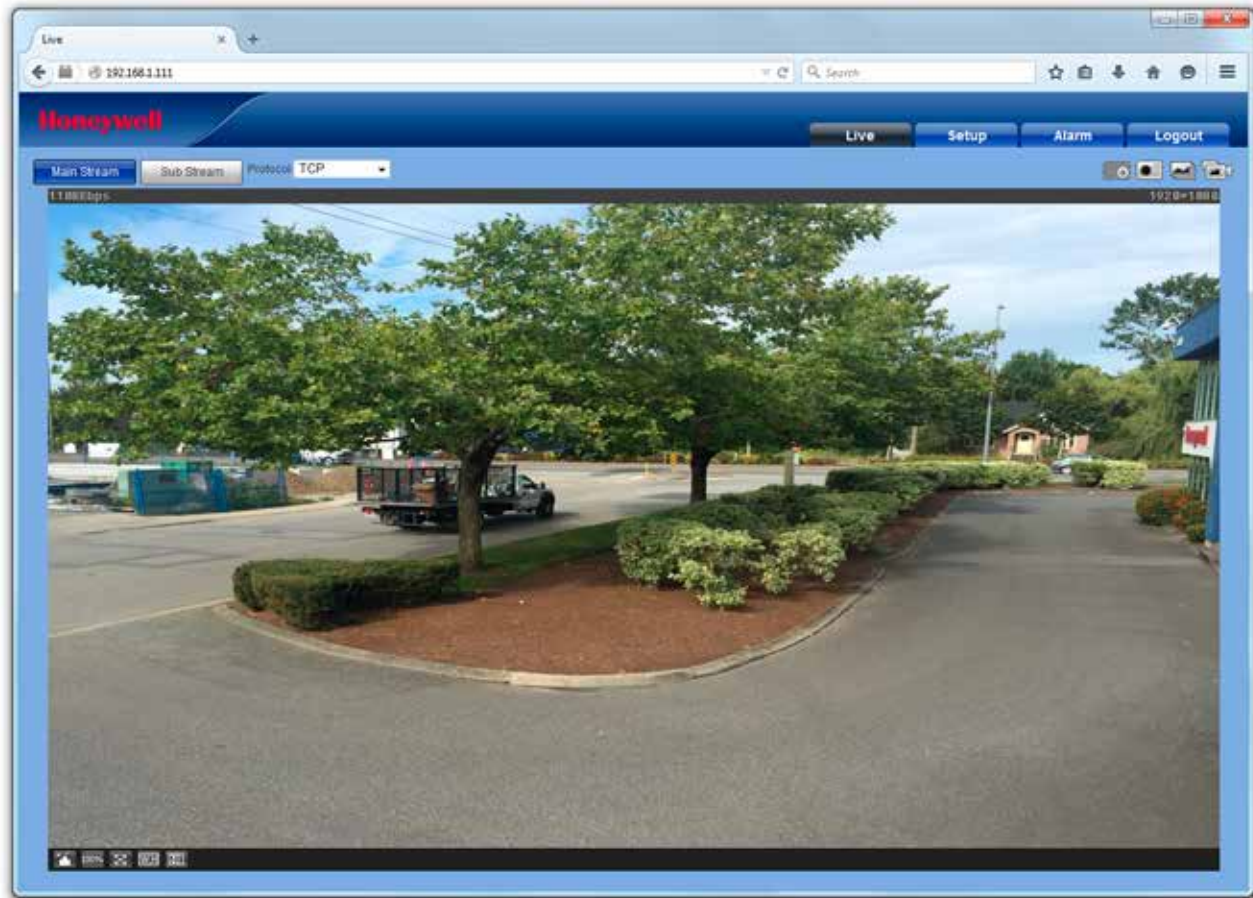

DIMENSIONS

H4W4PRV3

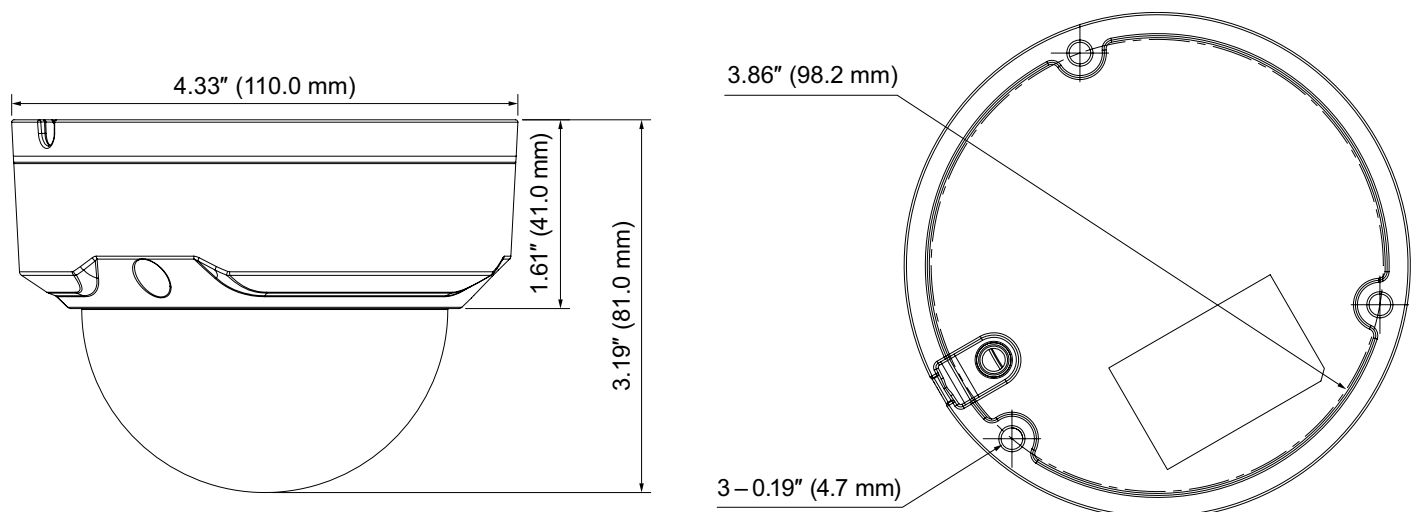

TDN WDR IR Mini Dome Camera

SPECIFICATIONS

OPERATIONAL			NETWORK	
VIDEO STANDARD		NTSC/PAL	ETHERNET	RJ-45 (10/100Base-T)
SCANNING SYSTEM		Progressive scan	PROTOCOLS*	IPv4/IPv6, HTTP, HTTPS, SSL, TCP/IP, UDP, UPnP, ICMP, IGMP, SNMP, RTSP, RTP, SMTP, NTP, DHCP, DNS, PPPoE, DDNS, FTP, IP Filter, QoS, Bonjour, 802.1X
IMAGE SENSOR		1/3" 4 MP CMOS	COMPATIBILITY	ONVIF Profile S*
NUMBER OF PIXELS (H×V)		2688×1520	MAX. USER ACCESS	20 users
MINIMUM ILLUMINATION		0.01 lux, F2.0 (color) 0 lux (with IR LEDs on)	MOBILE DEVICES	iPhone, iPad, Android
S/N RATIO		50 dB or more	ELECTRICAL	
ELECTRONIC SHUTTER SPEED		Auto, Manual, 1/3–1/100 000 s	POWER SUPPLY	PoE (802.3af), 12 VDC
IR DISTANCE		Up to 98 ft (30 m), depending on scene reflectance	POWER CONSUMPTION	4.0 W max.
DAY/NIGHT		Auto(ICR)/Color/BW	MECHANICAL	
BACKLIGHT COMPENSATION		BLC/HLC/WDR (120 dB)	DIMENSIONS	4.33 × 3.19 in. (110.0 × 81.0 mm)
WHITE BALANCE		Auto/Sunny/Night/Outdoor/ Customized	PRODUCT WEIGHT	0.73 lb (0.33 kg)
GAIN CONTROL		Auto/Manual	PACKAGE WEIGHT	1.04 lb (0.47 kg)
NOISE REDUCTION		3DNR	CONSTRUCTION	Die-cast aluminum housing with powder coat
PRIVACY MASKING		Up to 4 areas	CONSTRUCTION COLOR	RAL 9003 (White)
LENS		2.8 mm, F2.0	ENVIRONMENTAL	
HORIZONTAL ANGLE OF VIEW		106°	TEMPERATURE	–22°F to 140°F (–30°C to 60°C)
CORRIDOR MODE		Yes	RELATIVE HUMIDITY	0–95%, non-condensing
VIDEO			INGRESS PROTECTION	IP66
VIDEO COMPRESSION		H.264/H.264H/H.264B/MJPEG	VANDAL RESISTANCE	IK10
RESOLUTION		4 MP (2688×1520/2560×1440)/ 3 MP (2304×1296)/1080p (1920×1080)/720p (1280× 720)/D1(704×576/704×480)/ CIF(352×288/352×240)	REGULATORY	
FRAME RATE	MAIN STREAM	4 MP (1–20 fps)/ 3MP (1–25/30 fps)	EMISSIONS	FCC Part 15, CE (EN 55032)
	SUB STREAM	D1/CIF (1–25/30 fps)	IMMUNITY	CE (EN 50130-4)
	TRIPLE STREAM	720p (1–20 fps)	SAFETY	North America UL Listed to UL/CSA 60950-1, CE (EN 60950-1) North America UL Listed to UL/CSA 60950-22, CE (EN 60950-22)
BIT RATE (H.264)		32 Kbps–10 Mbps		

* Some development may be required in specific user cases to support some of these protocols in the field as they mature over time.

TDN WDR IR Mini Dome Camera

SPECIFICATIONS

SYSTEM INTEGRATION
OPEN IP INTEGRATION

ONVIF support and open API software integration. Refer to www.onvif.org for the ONVIF specification and the Honeywell Open Technology Alliance website (<http://www.security.honeywell.com/hota/>) to learn more about our open and integrated solutions.



ORDERING

ACCESSORIES	
MOUNTS	
HQA-BB2	Junction box
HQA-WK	Wall mount
HQA-PM	Pole mount (requires HQA-BB2)
HQA-PM2	Pole mount (requires HQA-BB2)
HB34S2-CM	Corner mount (requires HQA-BB2)
CAMERAS	
H4W4PRV3	Network TDN WDR IR Mini Dome Camera, 1/3" CMOS, 4 MP, 2.8 mm Fixed, 24 IR LEDs, PoE, H.264

For more information
www.honeywell.com/security

Honeywell Security and Fire
2700 Blankenbaker Pkwy, Suite 150
Louisville, KY 40299
1.800.323.4576
www.honeywell.com

Honeywell reserves the right, without notification, to make changes in product design or specifications.

L/TDNWDRIRMD/D | 04/17
© 2017 Honeywell International Inc.

