

CDC/CD Series CYLINDRICAL LOCKSET

ANSI/BHMA A156.2-2011

GRADE 1 CERTIFIED

UL 10C 3-HOUR RATED

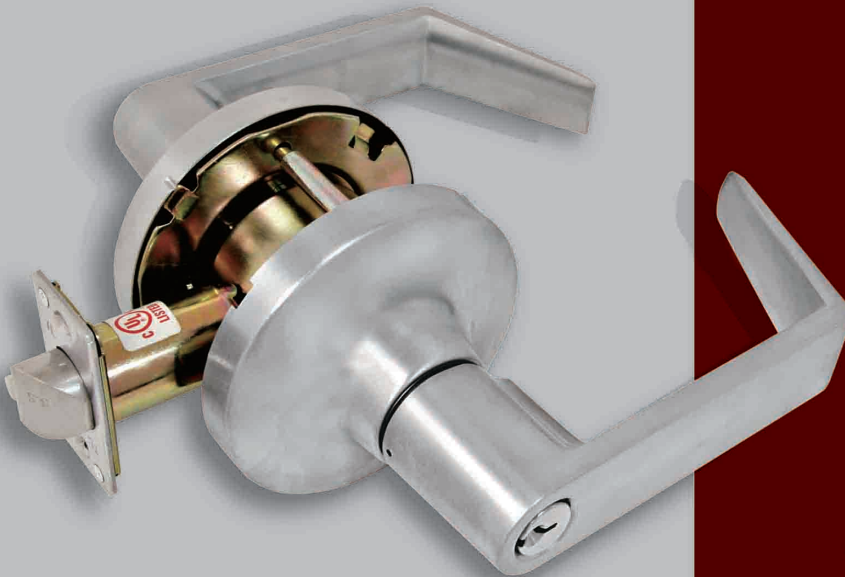

Quest(Q)



Gala(G)



Sentinel(S)



Schlage® LFIC



PRODUCT INTRODUCTION

CDC/CD Series Cylindrical Lockset is ANSI/BHMA A156.2-2011 Grade certified and UL 10C 3-Hour rated. It offers clutched and non-clutched feature. Independent torsion springs design provides effective lever support. It offers three types of lever available in US26D and US10B finishes. Multiple functions are available. Easy installation.



CATALOG

Index

Specifications —	3
Code Compliance —	3
Lever Profile —	4
Lock Profile —	5
How To Order —	5
Lock Profile —	6
—	—

Specifications:

Applications	Institutional, government/military, retail and multi-family
Handing	Non-Handed.
Door Thickness	1-3/8"-2" (35mm-51mm).
Backset	2-3/4" (70mm) standard, 2-3/8" 3-3/4" and 5" (60mm, 95mm, 127mm) optional.
Faceplate	Forged brass or Stainless Steel, 1-1/8" X 2-1/4" (29mm X 57mm) square corner, beveled.
Lock Chassis	Zinc plated for corrosion resistance.
Latch Bolt	Stainless Steel, 1/2" (12.7mm) throw, deadlocking on keyed functions. Anti-friction fire door latch with 3/4" (19mm) throw available upon request
Exposed trim	Wrought brass or stainless steel rose. Pressure case zinc lever
Strike	ASA curved lip Strike 1-1/4" x4-7/8" x1-5/16" lip to center (31.4mm x 123.5mm x 33.3mm). T-Strike available.
Cylinder	6pin solid brass cylinder with 2 brass keys per lock. Schlage "C" keyway.
SFIC	Small Format Interchangeable Core Cylinder, 6 or 7 pin, Best keyway.
LFIC	Schlage® Large Format IC Less Core Available, Sentinel lever only.
Keying Options	Master keying, grand master keying and construction.
Free-Wheeling Mechanism	standard, non-clutch available.
Finishes	US26D, US10B stock finishes, other upon request.
Functions	ANSI F-75,76, 84, 86, 87,90, 109 and 110 stock functions, other upon request.
Lever Style	Sentinel, Quest, Gala.
Door Preparation	Standard 161 door prep with 2-3/4" (70mm) center to center thru-bolt.
Warranty	10 years limited for mechanical, 5 years for finishes.

Code Compliance:

- o **ANSI/BHMA**
Certified ANSI/BHMA A156.2-2011 Series 4000 Grade 1.
- o **California State Reference Code (CSFH)**
Sentinel and Quest lever return to within 1/2" of door face.
- o **UL/ULC**
All locks listed for A label single doors, 4'x8'.
- o **Buy American Act (BAA) Compliant**
All locks meet requirements of the Buy American Act.
- o **Americans with Disability Act (ADA) Compliant**
All locks meet requirements of the Americans with Disability Act.



Lever Profile

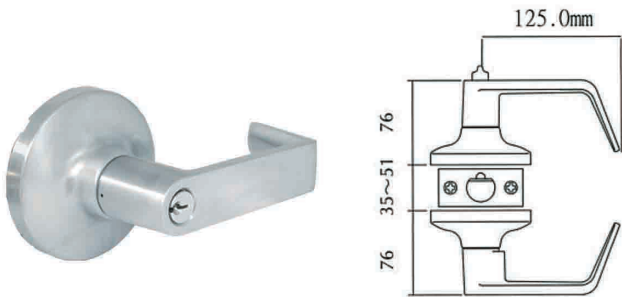

Sentinel(S)

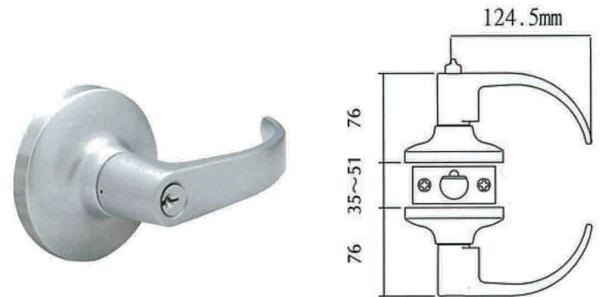

Quest(Q)

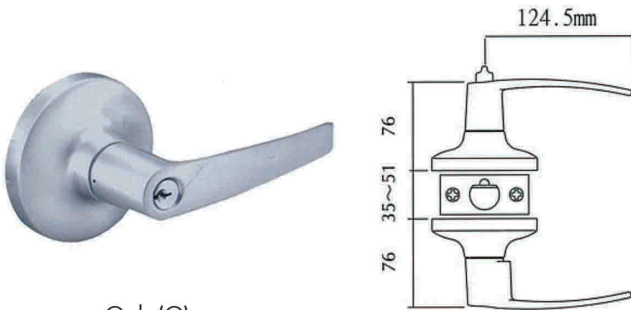

Gala(G)

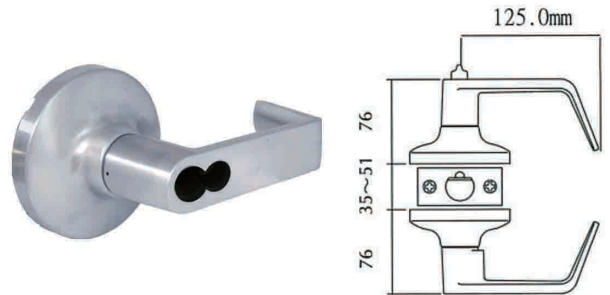

Schlage® LFIC
(Available in Sentinel Lever Only)



ASA Strike

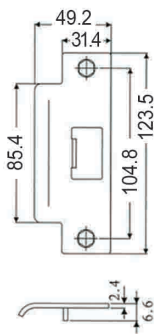

Lock Profile

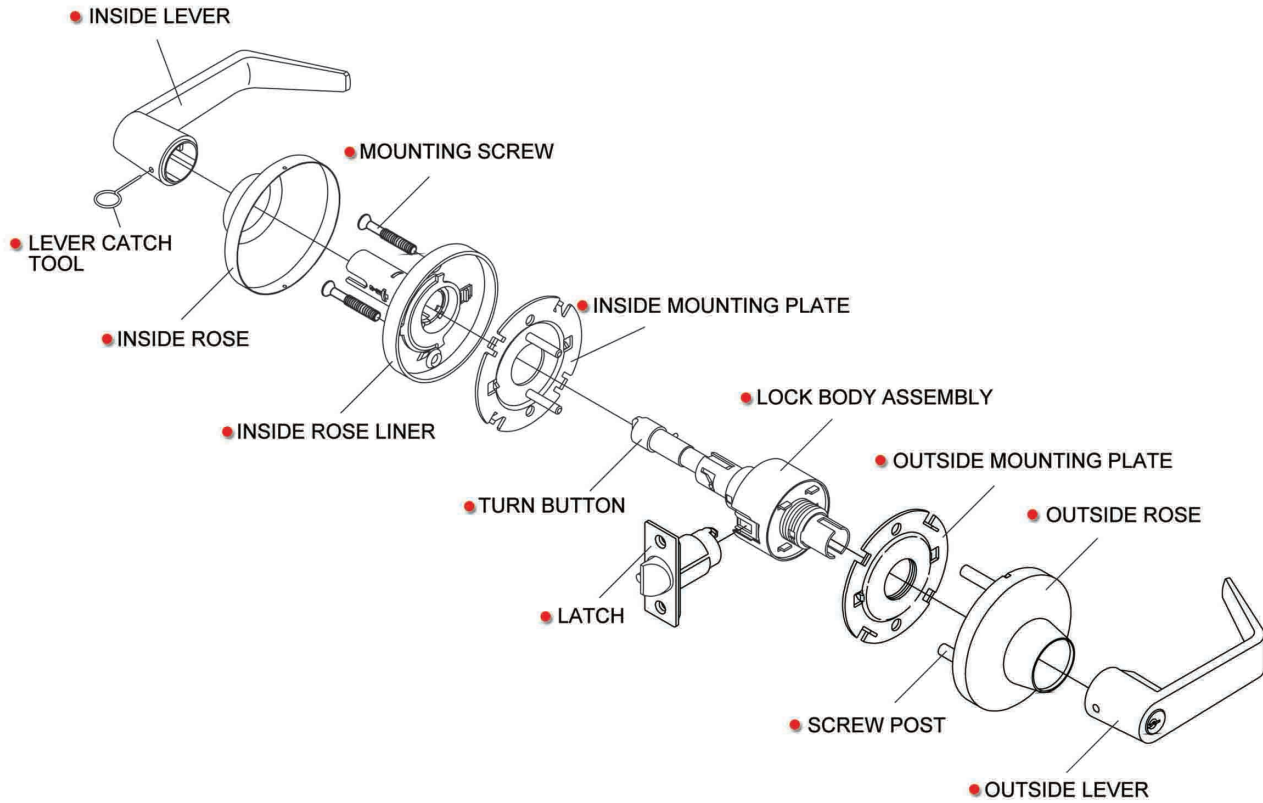

How to Order

Series	Function	Lever	Finish	Backset	Keying
CDC: Regular Trim, Clutched	Refer to function sheet	Sentinel(S) Quest(Q) Gala(G)	US26D US10B	Blank-2-3/4" 2-3/8" 3-3/4" 5"	Blank-KD KA-Keyed alike MK-Master Keyed GMK-Grand Master Keyed
CDCI: SFIC Less Core, Clutched					
CD: Regular Trim, Non-Clutched					
CDC-SLFIC: Schlage® LFIC Less Core, Clutched					
Example:				CDC - 84 - S - US26D - KA	
CDC: Regular Trim, Clutched	Function: Classroom Function	Lever: Sentinel Lever	Finish: Satin Chrome Finish	Backset: 2-3/4" backset	KA: Keyed Alike

Lock Function

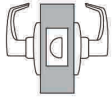
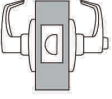
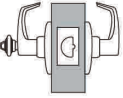
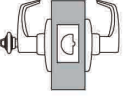
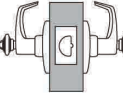
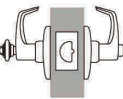
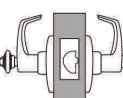
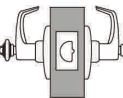
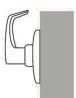
Outside	Inside	Series/ Function	Type	ANSI No.	Function Description
		CDC-75	Passage Closet	F75	Latchbolt operated by lever from either side at all times.
		CDC-76	Privacy	F76	Latchbolt operated by lever from either side. Outside lever is locked by push button inside and unlocked by emergency release outside, rotating inside lever or closing door.
		CDC-84	Classroom	F84	Deadlocking latchbolt operated by lever from either side except when outside lever is locked from outside by key. When outside lever is locked, latchbolt is operated by key in outside lever or by rotating inside lever.
		CDC-86	Storeroom	F86	Deadlocking latchbolt operated by key in outside lever or rotating inside lever. Outside lever is always inoperable.
		CDC-87	Asylum	F87	Deadlocking latchbolt operated by key in lever from either side. Both lever always fixed.
		CDC-90	Corridor Lock	F90	Dead locking latch bolt operated by lever from either side except when outside lever is locked by key in outside lever or by push button or other locking device on inside. Key in outside lever locks or unlocks outside lever. Operating inside lever releases push button or other locking device placed. Closing door releases push button or other inside locking device. Inside lever always operates latch bolt.
		CDC-109	Entry / Office Lock	F109	Deadlocking latchbolt operated by lever from either side, except when outside lever is locked by the push or turn button on inside. Key outside or operating inside lever releases push or turn button unlocking outside lever except when push or turn button has been rotated to keep outside lever locked. Inside push or turn button must be manually operated to unlock outside lever. Inside lever always operates latch bolt.
		CDC-110	Intruder Classroom Lock	F110	Dead locking latch bolt operated by lever from either side. Key either inside or outside locks or unlocks outside lever. Inside lever always operates latch bolt.
		CDC-SD	SINGLE DUMMY TRIM	SD	Dummy trim for one side of door.



17901 Railroad Street, City of Industry, CA 91748

Toll Free: (877) 858-0888

Tel: (626)965-8917

Fax: (626) 965-8919

sales@townsteel.com