

# 7500 Series

## Standalone Keypad/Prox Card Reader



MODEL #7500

- **Weather and Vandal Resistant**
- **High Visibility Blue Backlit Keypad**
- **Supports Up to 500 Users**
- **Built In Tamper Detection**
- **Lifetime Warranty**

### Description

The 7500 is an advanced single gang standalone digital keypad with built-in proximity card reader. This unit offers large backlit metal keys and a built-in heater which makes the 7500 ideal for high traffic, harsh environment applications. A wide array of functions and auxiliary modes provide extra flexibility and security, allowing it to operate as a single or two-door access controller.

The 7500 offers ease of installation and programming due to its removable terminal blocks for simple wire connections and flexible programming capabilities such as a unique "code search" for simple user management. A flexible power input allows the unit to operate on 12-24VDC or 16-24VAC. Two Form-C relay outputs, rated at 2 amps, as well as REX and Auxiliary inputs are provided.

### Standard Features

- **500 User Codes:** Up to 500 users can have PIN and/or RFID credentials for access.
- **Flexible Power Input:** 12-24 VDC or 16-24VAC.
- **3 User and Access Levels:** Program one to three different levels of access for each individual user or for the entire system.
- **Multiple Inputs and Outputs:** Unit includes a REX and Auxiliary input as well as two form C output contacts rated at 2 Amps.
- **Audio and Visual Recognition:** Equipped with an internal sounder and two tri-colored status/programming LED's.
- **Multiple Auxiliary Modes:** Ten programmable auxiliary modes including: Door Ajar, Forced Door, Alarm Shunt, and Door Monitor.
- **Built-In Heater:** Automatically activates to prevent key freeze at 4°F (-20°C).
- **Vandal Resistant:** Metal casing with a built in optical tamper sensor.
- **Installer Friendly:** Removable terminal blocks simplify wire connections. Unit also includes an installation kit and self-adhesive mounting template.
- **Lifetime Warranty**

# 7500 Series Digital Keypad/Prox Card Reader

## Specifications

### Physical Characteristics

Size: 4.72" H x 3" L x 1.06" W  
 Weight: 1 lbs  
 Material: Vandal-resistant metal

### Electrical Characteristics

Voltage Range: 12-24VDC, From a power supply  
 16-24VAC, From a transformer  
 Input Current: Standby: 85mA at 12VDC (Heater Off)  
 Maximum: 145mA at 12VDC (Heater Off)  
 Standby: 565mA at 12VDC (Heater On)  
 Maximum: 625mA at 12VDC (Heater On)  
 Relay Outputs: Main: 2A Form C, N.O. and N.C.  
 Auxiliary: 2A Form C, N.O. and N.C.  
 Tamper: Optical back tamper sensor  
 Inputs: REX: N.O. dry contact  
 Auxiliary (In/Monitor): N.O. dry contact  
 10 programmable modes  
 Proximity Reader: Maximum Read Range: 2.5"  
 Modulation: ASK at 125kHz  
 Compatible Cards: All 26-Bit EM Cards

### Environmental Characteristics

Operation: Water resistant, suitable for outdoor use  
 Meets IP54  
 Temperature: -20°C to 60°C ( -4°F to 140°F )  
 Humidity: 0 to 95% (non-condensing)  
 RFI Protection: >20V/m up to 1000Mhz

### Operational Characteristics:

Capacity: 500 users, single/dual code for each  
 Keypad: 3x4 key pad for local programming  
 4 to 8 digit PIN code entry  
 User Levels: Normal/Secure/Master  
 Security Modes: Normal, Bypass and Secure  
 Audio/Visual: Built-in sounder  
 Interface for external audible  
 (bell, chime and siren)  
 Two tri-colored LED indicators

7500 SERIES ACCESSORIES	
 7551	Read-Only 125KHz Clamshell Proximity Card White Unprinted
 7561	Read-Only 125KHz Proximity Tag Ring Design Gray
 7571	Read-Only 125KHz Proximity Tag Wafer Design Gray

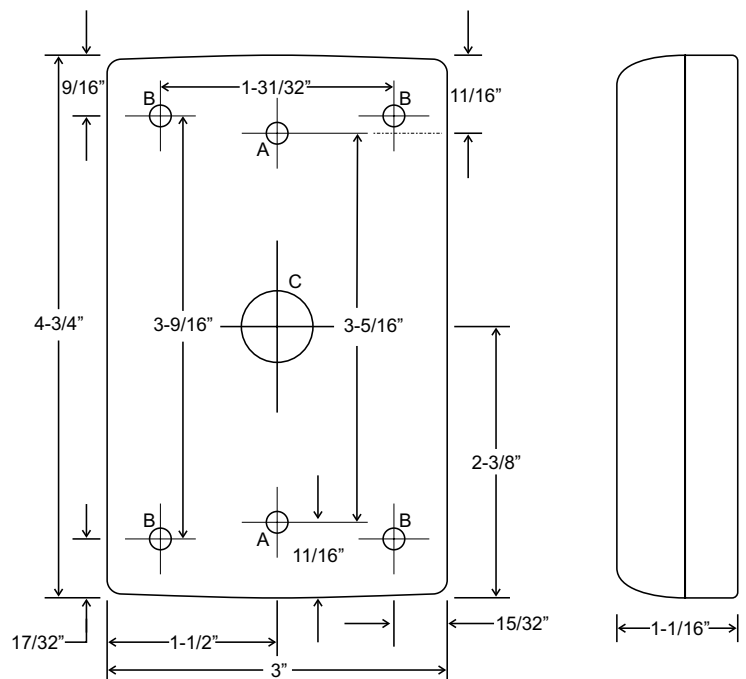

A: MOUNTING HOLES FOR SINGLE GANG BOX  
 B: MOUNTING HOLES FOR FLAT PANEL  
 C: WIRE ROUTING ACCESS HOLE

**DYNALOCK CORPORATION**  
 705 EMMETT STREET / PO BOX 2728  
 BRISTOL, CT 06011-2728  
 PHONE: 877-DYNALOCK / FAX: 860-585-0338  
 E-MAIL: INFO@DYNALOCK.COM  
 WEBSITE: WWW.DYNALOCK.COM

Featuring  
  
**DynaLife**<sup>®</sup>  
 Lifetime Warranty