

PARALLEL ARM (PUSH SIDE) MOUNT

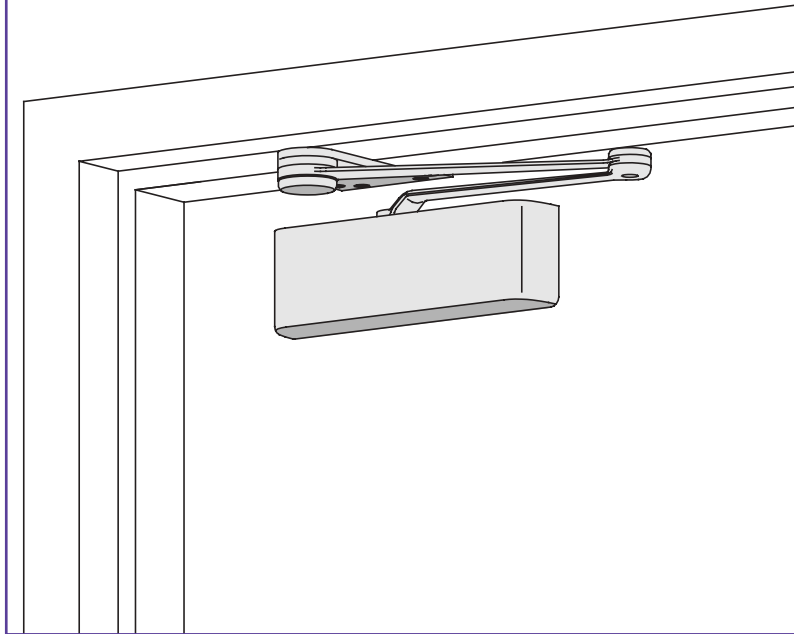

The 4130 offers the best economy in a heavy duty closer designed specifically for interior doors in moderate traffic applications.

- ▶ **Cast Iron**
- ▶ **Forged Steel Arm**
- ▶ **Heat Treated Steel Pinion**
- ▶ **All Weather Fluid**
- ▶ **UL & ULC Listed**

- ▶ Standard 4130 series closer shipped with regular arm, standard plastic cover, 4130-201 FIFTH SCREW SPACER and wood and machine screws. See 4130 Series pages 59 for options.
- ▶ Choice of sized cylinders for interior doors to 38".
- ▶ Handed closer mounts parallel arm, specify right or left swinging door.
- ▶ Closers to meet ADA requirements. See 4130 Series page 60.
- ▶ Standard or optional custom powder coat finish.
- ▶ Optional plated finish on cover, arm, and fasteners.
- ▶ Optional SRI primer for installations in corrosive conditions.
- ▶ The 4130 Series is UL and ULC listed with regular arm for self-closing doors.
- ▶ Tested and certified under ANSI Standard A156.4, grade one.

MOUNTING					FINISH		COVER	CYLINDER					**ARM FUNCTION											
HINGE (PULL) SIDE		TOP JAMB (PULL)		TOP JAMB (PUSH)	PARALLEL ARM		STOP FACE	POWDER COAT	PLATED	PLASTIC	METAL	DESIGNER METAL	NON-HANDED	NON-SIZED	ACCESSIBILITY	DELAYED ACTION	AVB***	REGULAR (DOUBLE)	STANDARD (SINGLE)	HOLD-OPEN	FUSIBLE LINK	EDA/HEDA	CUSH/H/CUSH	SCUSH/SH/CUSH
<input type="radio"/>	<input type="radio"/>	<input type="radio"/>	<input checked="" type="radio"/>	<input type="radio"/>	<input checked="" type="radio"/>	<input checked="" type="radio"/>	<input type="radio"/>	<input checked="" type="radio"/>	<input checked="" type="radio"/>	<input type="radio"/>	<input type="radio"/>	<input type="radio"/>	<input type="radio"/>	<input type="radio"/>	<input type="radio"/>	<input type="radio"/>	<input type="radio"/>	<input type="radio"/>	<input type="radio"/>	<input type="radio"/>	<input type="radio"/>	<input type="radio"/>	<input type="radio"/>	<input type="radio"/>

- Available
○ Not available

♿ Closer available with less than 5.0 lbs. opening force on 36" door.
 **Maximum opening/hold-open point with standard template.
 *** Advanced Variable Backcheck

LCN 4130 SERIES

PARALLEL ARM (PUSH SIDE) MOUNTING

MAXIMUM OPENING

Can be templated for

100°,

Ⓐ = 5 1/4" (133 mm)

Ⓑ = 7" (178 mm)

140°,

Ⓐ = 3 1/2" (89 mm)

Ⓑ = 5 1/4" (133 mm)

or 180°.

Ⓐ = 3/4" (19 mm)

Ⓑ = 2 1/2" (64 mm)

Hold-open points up to maximum opening with hold-open arm.

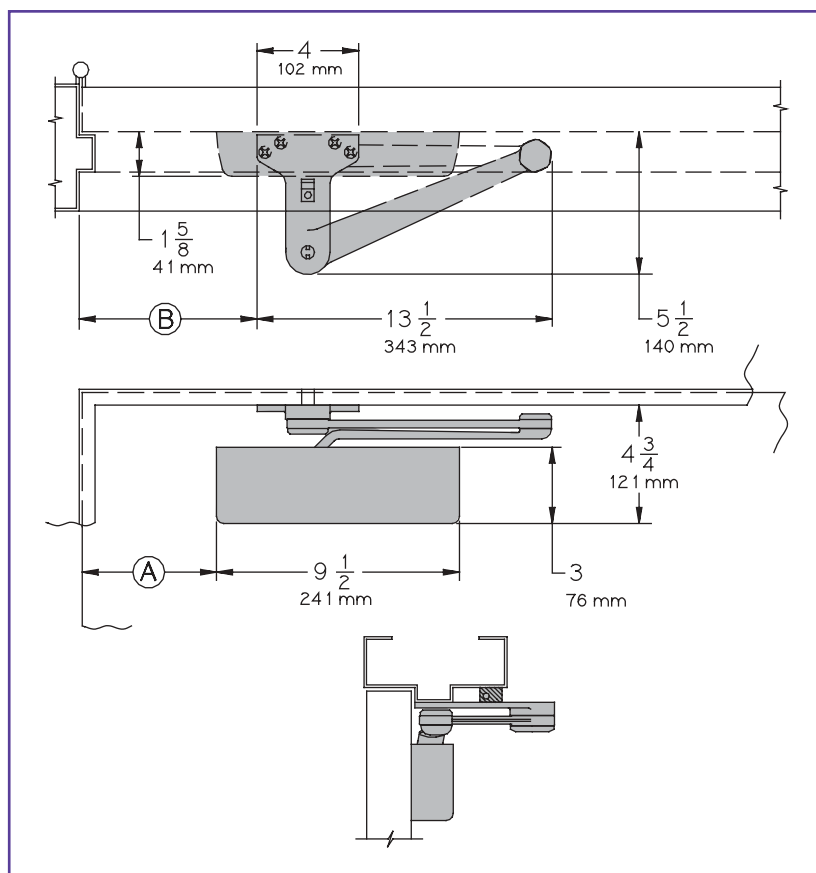

- ▶ **Butt Hinges** should not exceed 4 1/2" (114 mm) in width for 180° installation.
- ▶ **Auxiliary Stop** is recommended at hold-open point or where a door can not swing 180°.
- ▶ **Clearance** for 4130-62 shoe is 5 1/2" (140 mm) from door face.
- ▶ **Top Rail** less than 4 3/4" (121 mm) measured from the stop requires SPECIAL TEMPLATE.
- ▶ **Head Frame** flush or rabbeted requires 4130-145 arm or PA SHOE ADAPTER, 4130-418.
Optional 4130-145 shoe available for flush transom installations.
- ▶ **Stop Width** minimum 1" (25 mm).
- ▶ **Reveal** less than 1 3/4" (44 mm) use SHOE SUPPORT, 4130-30.
- ▶ **Blade Stop Spacer**, 4130-61 required for PA arm to clear 1/2" (13 mm) blade stop.

Options

- ▶ Hold-open arm.
- ▶ Metal cover or Lead lined cover

Special Templates

Customized installation templates or products may be available to solve unusual applications. Contact LCN for assistance.

CYLINDERS

CYLINDER, 4130-3071

Standard, handed cast iron cylinder assembly.

For various applications see "Table of Sizes" on 4130 Series page 60.

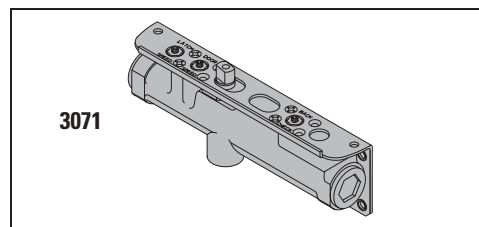

COVERS

COVER, 4130-72

Standard, non-handed plastic cover.

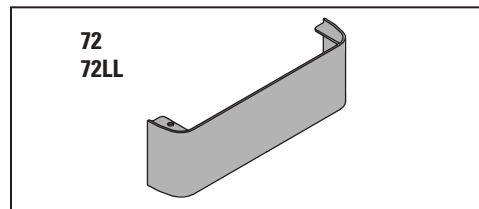

LEAD LINED COVER, 4130-72LL

Standard, non-handed cover.

METAL COVER, 4130-72MC

Optional, non-handed cover. Required for plated finishes and custom powder finishes.

Installation kit included.

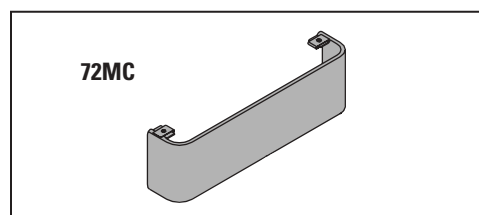

ARMS

EXTRA DUTY ARM, 4130-3077

Standard, non-handed arm with forged steel main and forearm.

Optional 4130-145 shoe for flush transom applications.

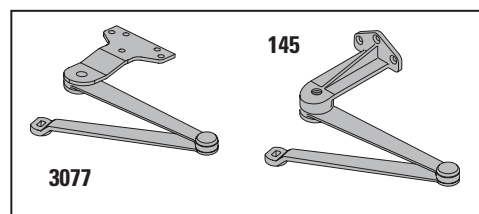

HOLD-OPEN ARM, 4130-3049

Optional, handed arm provides hold-open function, adjustable at shoe.

Optional 4130-145H shoe for flush transom applications.

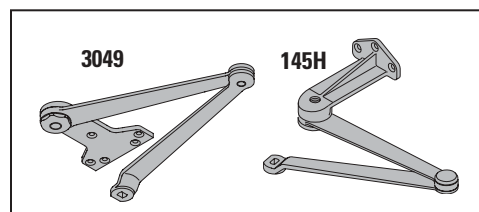

INSTALLATION ACCESSORIES

SHOE SUPPORT, 4130-30

Provides anchorage for fifth screw, where reveal is less than 1 3/4" (44 mm).

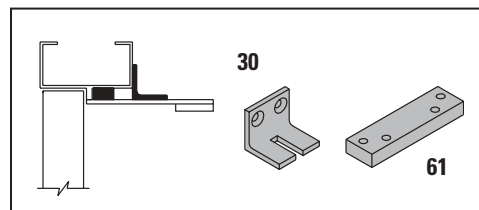

BLADE STOP SPACER, 4130-61

Lowers parallel arm shoe to clear 1/2" (13 mm) blade stop.

FLUSH PANEL ADAPTER, 4130-419

Provides horizontal mounting surface for parallel arm shoe on single rabbetted or flush frame.

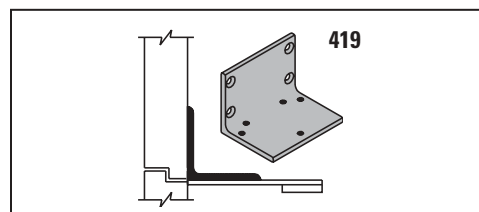

LCN 4130 SERIES

TABLE OF SIZES Select closer based on width of door.
The 4130 cylinder is available in size 1, 2, or 3. Spring power is not adjustable.
Where severe conditions or potential for abuse exists, use 4110 Series closer.

→ Indicates recommended range of door width for closer size.

INTERIOR DOOR WIDTH

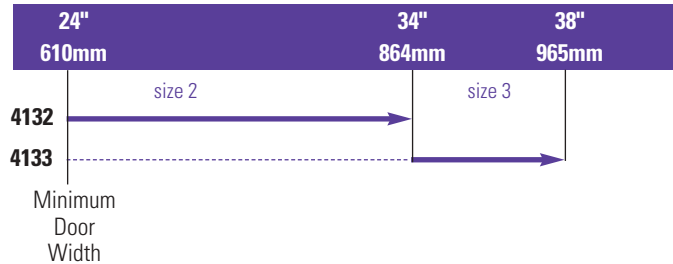

REDUCED OPENING FORCE 4130 CLOSERS

CAUTION ! Any manual door closer, including those certified by BHMA to conform to ANSI Standard A156.4, that is selected, installed and adjusted based on ADA or other reduced opening force requirements may not provide sufficient power to reliably close and latch a door.

Refer to POWER OPERATORS section for information on systems that meet reduced opening force requirements without effecting closing power.

	DOOR WIDTH	36"	42"	48"
	8.5* lbs.	N/A	N/A	N/A
	5.0* lbs.	4131	4131	4132

* Maximum opening force

HOW-TO-ORDER 4130 SERIES CLOSERS

1. SELECT CYLINDER SIZE

- ☐ 4131 (ADA)
- ☐ 4132
- ☐ 4133

2. SPECIFY HAND

- ☐ RH
- ☐ LH

3. SPECIFY FINISH

- ☐ Standard Powder Coat _____
Aluminum, Dark Bronze, Tan, Statuary,
Light Bronze, Black, Brass.

Closer will be shipped with:

- STANDARD COVER,
 - FIFTH SCREW SPACER
 - REGULAR ARM,
 - WOOD & MACHINE SCREWS,
- unless options listed below are selected.

CLOSER OPTIONS

COVER

- ☐ Lead Lined (LL)
- ☐ Metal (MC)

ARM

- ☐ Hold-open

FINISH

- ☐ Custom Powder Coat (RAL) _____
(handed metal cover required)
- ☐ Plated Finish, US _____
(handed metal cover required)
- ☐ SRI primer

SCREW PACK

- ☐ TB*, Wood & Machine Screw (TBWMS)
- ☐ TORX Machine Screw
- ☐ TB* & TORX Machine Screw (TBTRX)

* Specify door thickness if other than 1 3/4".

INSTALLATION ACCESSORIES

- ☐ Shoe Support, 4130-30
- ☐ Blade Stop Spacer, 4130-61
- ☐ Flush Panel Adapter, 4130-419

SPECIAL TEMPLATE

- ☐ ST- _____