

1700 SERIES

Light Commercial
Door Closer



Norton®

ASSA ABLOY

ASSA ABLOY, the global leader
in door opening solutions

OVERVIEW

Norton® 1700 Series Door Closers are multi-feature closers whose compact design is ideal for application on interior doors. This narrow-stile closer has distinctive lines that harmonize with most decors. It is available with a full cover to provide an installation with compatible appearance to other door closers with covers. The Norton 1700 Series Door Closer offers an economical alternative for those installations where a more heavy-duty closer is not necessary.

Standard Features

- Tri-Style® packaging: closer tri-packed for regular arm, top jamb or parallel arm installation.
- Non-handed
- Aluminum alloy shell
- Rack & pinion operation
- Adjustable closing speed
- Adjustable latch speed
- Non-hold open

Optional Features

- Adjustable backcheck cushioning: independent regulating valve; order 1700BC series.
- Full molded cover: order 1700COV/1700BCCOV.
- Hold open: order 1700H/1700BCH

SPRAYED FINISHES

| Description | Specify Norton (BHMA) Designation | Complements the following finishes | Old Norton Designation |
|-----------------|-----------------------------------|------------------------------------|------------------------|
| Aluminum | 689 | 628, 625, 629, 630, 651, 652 | AL |
| Statuary Bronze | 690 | 640, 613 | STAT |
| Dull Bronze | 691 | 612, 637, 639 | DB |
| Black | 693 | 315 | 315 |
| Medium Amber | 694 | 312 | 312 |
| Gold | 696 | 605, 606, 632, 633 | GB |
| Prime Coat* | 600 | | SRI |

*600 is a special rust-inhibiting prime coat. Closers can be ordered prime coat only (specify closer x 600). An additional charge applies if finish coat is required over prime coat (ex: 1704 x 600 x 689).

TABLE OF CONTENTS

| | |
|---------------------------|---|
| How To Order | 3 |
| Suggested Specifications | 3 |
| Compliance Standards | 3 |
| Sizing Chart | 3 |
| Accessories | 4 |
| Regular Arm Installation | 5 |
| Top Jamb Installation | 6 |
| Parallel Arm Installation | 7 |

1700 SERIES

LIGHT COMMERCIAL DOOR CLOSER

GLOSSARY OF TERMS

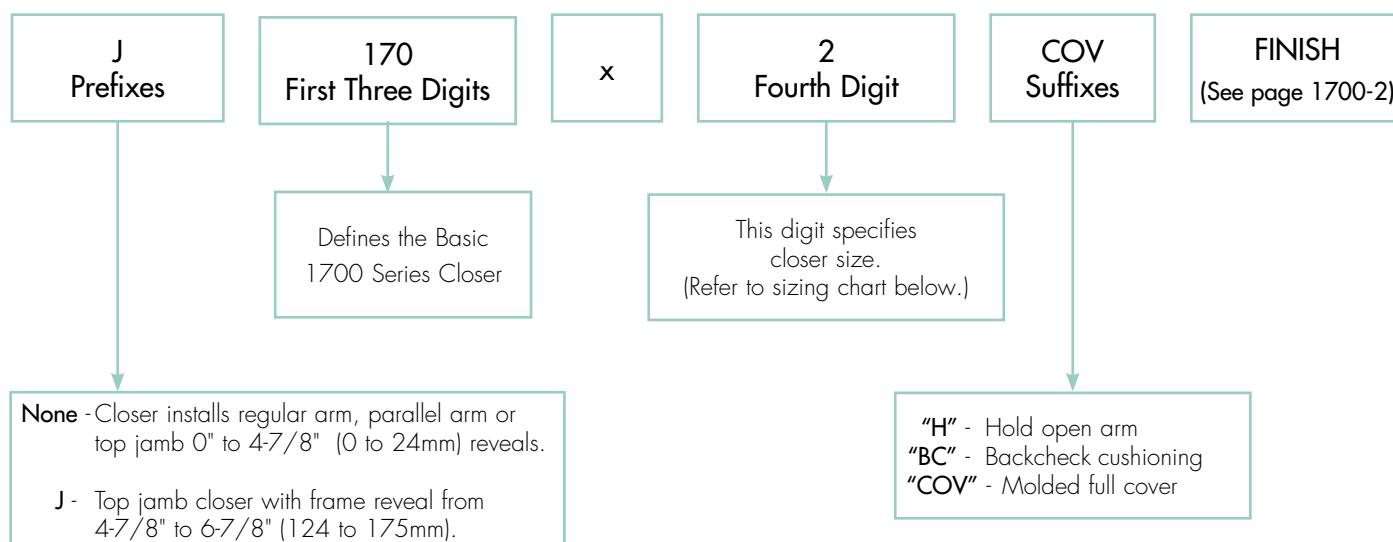

Fasteners

Through-bolts, grommet nuts and sex nuts are available to special order.

Suggested Specifications

Closers for interior doors shall be full rack-and-pinion type with cast aluminum alloy shell. Closer shall be non-handed to permit installation on either hand of door. Closer to be supplied with brackets to allow regular arm, parallel arm or top jamb mounting. Closer to have non-critical valves to independently regulate sweep speed (and) latch speed (and backcheck cushioning.) The forearm bracket shall permit a 15% power adjustment by rotating the forearm and bracket 180° at the door or frame. (Closer shall be enclosed in a molded full cover.) Closer to be Norton 1700/1700BC Series, 1700COV/1700BCCOV Series.

Compliance Standards

All series 1700 comply with ANSI/BHMA A156.4 Grade 2 specification. **BHMA CERTIFIED** **UL** All Norton series 1700 closers with non-hold open arms are listed by Underwriters' Laboratories for labeled fire doors. This includes compliance to UL10C for 3-hour assemblies. The product is manufactured in an ISO 9001 facility.

SIZING CHART

| Model Number | | Interior Doors: Maximum Size Wood or Metal (cm) | | |
|---------------|-----------|---|--------------|-----------|
| | | Type of Installation | | |
| Non-Hold Open | Hold Open | Regular Arm | Parallel Arm | Top Jamb |
| 1701(BC) | 1701(BC)H | The 1701 closer (size 1) is intended for use on doors with a minimum clear opening width of 2'8" (81cm) to provide less than 5.0 lbs. (22.2N) of door opening resistance. | | |
| 1702(BC) | 1702(BC)H | 30" (76) | 30" (76) | 30" (76) |
| 1703(BC) | 1703(BC)H | 36" (91) | 32" (81) | 36" (91) |
| 1704(BC) | 1704(BC)H | 42" (107) | 36" (91) | 42" (107) |

Door width information is based on 1-3/4" (44mm) x 7" (2.13m) standard weight doors swinging 110°. Other conditions (such as door height, weight, or draft conditions) may require a larger size closer.

Note: Contact factory if door weight exceeds 250 lbs.

ACCESSORIES

| Part Number | Description |
|-------------|--|
| 1700-1 | Arm Assembly - Non-Hold Open |
| 1700-3 | Arm Assembly - Hold Open |
| 17P | Cover |
| 1739 | Pinion Cap |
| 1788 | Parallel Arm Adapter Plate (Hold Open) |
| 1789 | Parallel Arm Bracket |
| 170XBCLAP | Closer Body* |

* X = specify closer size

Door Plates

For narrow top rails, narrow frame faces, and top jamb hold open installations. Plates vary in size when the closer is ordered with or without a full molded cover. Order drop plates from the chart. Specify finish when ordering separately.

| Type Of Installation | Drop Plate Model Number | |
|----------------------|-------------------------|------------|
| | Without Cover | With Cover |
| Regular Arm | 1746 | 1756 |
| Top Jamb | 1746 | 1757 |
| Parallel Arm | 1748 | 1758 |

For drop plate requirements, see Dimensional Information pages 5-7.

Molded Full Cover

Molded of high-impact U.L. Listed material for completely enclosing the closer body, mounting screws and the unused pinion shaft. This cover is non-handed. It has two notches; one for clearance of the pinion shaft. An insert is included for insertion into the unused notch. Four molded catches engage the closer body for easy yet secure installation. To order this cover separately, specify 17P x finish.

1700 SERIES LIGHT COMMERCIAL DOOR CLOSER

REGULAR ARM INSTALLATION

Closer mounts on door;
Arm bracket on frame face.

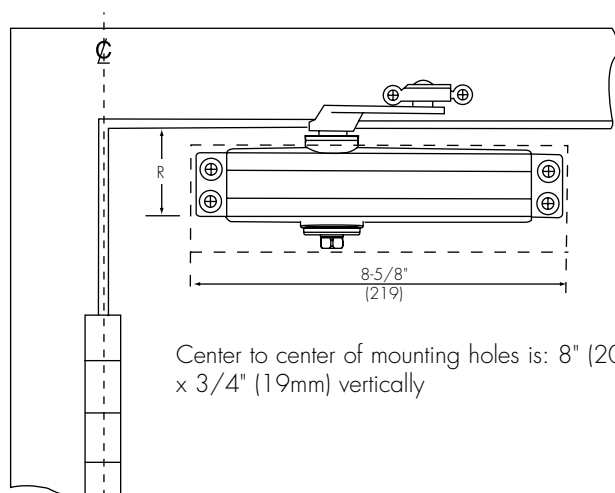

Center to center of mounting holes is: 8" (203mm) horizontally
x 3/4" (19mm) vertically

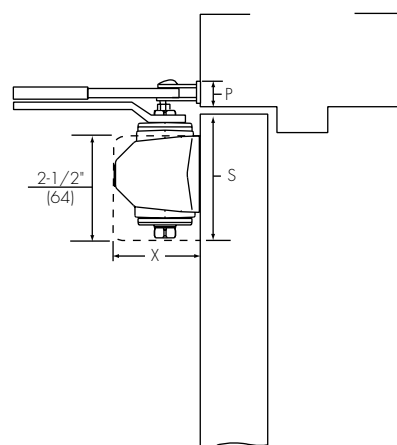

| R Minimum Top Rail | | | | S Minimum Top Rail Clearance | | P Minimum Ceiling Clearance Without Drop Plate | | X Closer Projection | |
|-----------------------|-----------|------------------------------|-----------|------------------------------------|----------------|---|----------------|------------------------|-----------------|
| Without Drop Plate | | With 1746/1756 Drop Plate | | Non-Hold Open | Hold Open | Non-Hold Open | Hold Open | Without Cover | With Cover |
| Non-Hold Open | Hold Open | Non-Hold Open | Hold Open | | | | | | |
| 2" (51) | | 1-1/4" (32) | | 3" (76) | 2-7/8" (73) | 1" (25) | 1-3/8" (35) | 1-15/16" (49) | 2-1/16" (52) |

Sizes based upon door 7'0" (2.13m) x 1-3/4" (44mm)

TOP JAMB INSTALLATION

Closer mounts on push side of frame; arm shoe mounts to door.

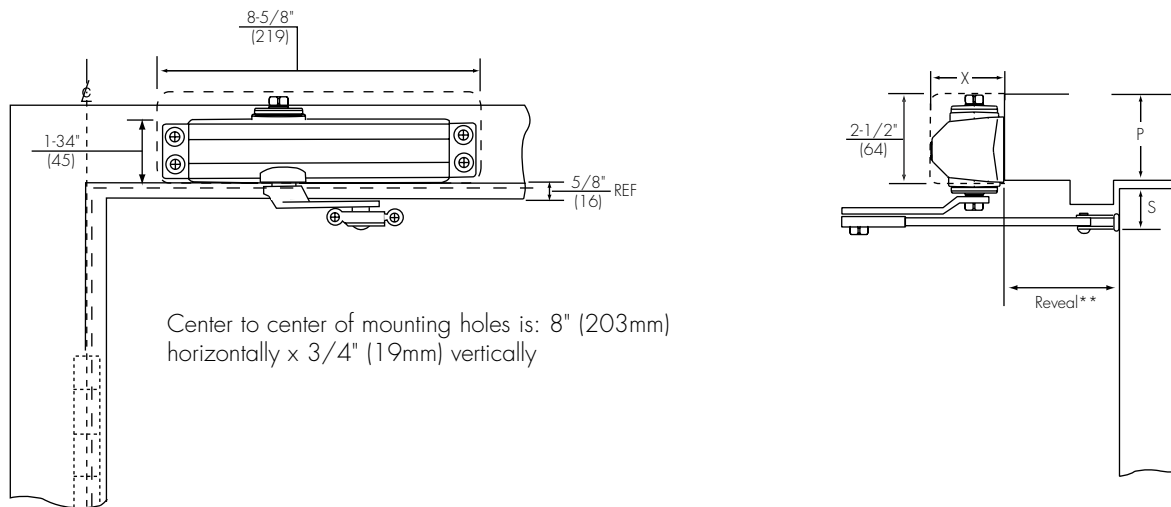

| S Minimum Top Rail Clearance | | | P Minimum Ceiling Clearance | | | | X Closer Projection | |
|---------------------------------|---------------------------|-------------|--------------------------------|---------------------------|---------------|-----------|------------------------|--------------|
| Without Drop Plate | With 1746/1757 Drop Plate | | Without Drop Plate | With 1746/1757 Drop Plate | | | | |
| Non-Hold Open | Non-Hold Open | Hold Open | Non-Hold Open | Hold Open | Non-Hold Open | Hold Open | Without Cover | With Cover |
| 1-1/4" (32) | 2-1/4" (57) | 2-5/8" (67) | 2-1/2" (64) | N/A*** | 1-3/4" (44) | | 1-15/16" (49) | 2-1/16" (52) |

Sizes based upon door 7'0" (2.13m) x 1-3/4" (44mm)

**Reveal Information

The standard 1700 Series non-hold open closers and 1700H Series hold open closers (Top Jamb mount) accommodate frame reveals for 0" to 4-7/8" (0 to 124mm).

J1700 Series non-hold open closers and J1700H Series hold open closers accommodate frame reveals from 4-7/8" to 6-7/8" (124 to 175mm). These closers are not supplied with "Tri-Style® installation" hardware.

***Use of hold open arm requires use of a drop plate.

1700 SERIES LIGHT COMMERCIAL DOOR CLOSER

PARALLEL ARM INSTALLATION

Closer Mounts on Door;
Bracket on frame soffit.

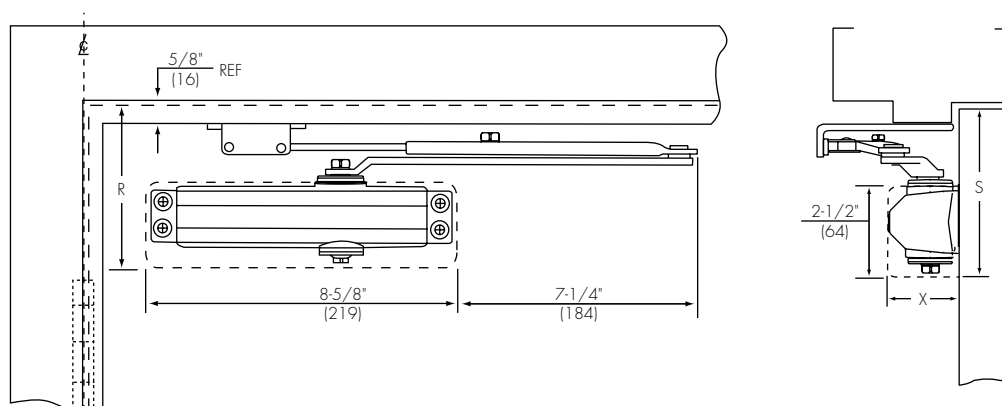
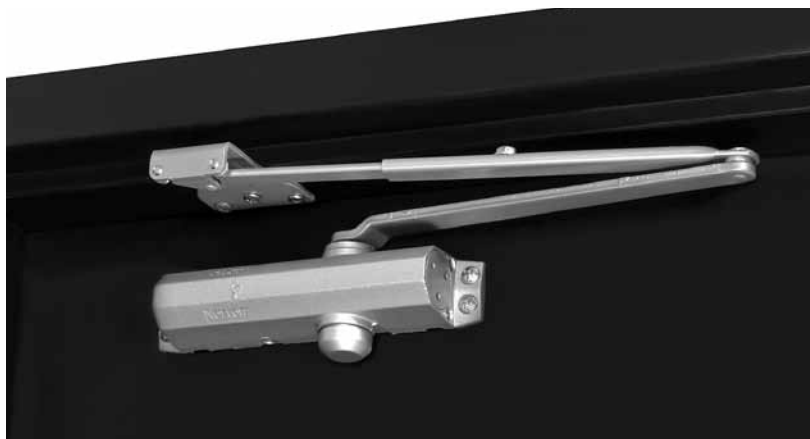

Center to center of mounting holes is: 8" (203mm)
horizontally x 3/4" (19mm) vertically

| R Minimum Top Rail | | | | S Minimum Top Rail Clearance | | X Closer Projection | |
|-----------------------|-----------------|------------------------------|-----------|------------------------------------|-------------|------------------------|-----------------|
| Without Drop Plate | | With 1748/1758 Drop Plate | | | | | |
| Non-Hold Open | Hold Open | Non-Hold Open | Hold Open | Non-Hold Open | Hold Open | Without Cover | With Cover |
| 4" (102) | 4-1/4" (108) | 2-1/4" (57) | | 4-3/4" (121) | 5" (127) | 1-15/16" (49) | 2-1/16" (52) |

CONTACT US AT:

Norton Door Controls
3000 Highway 74 East
Monroe, NC 28112
Tel: 877-974-2255
Fax: 800-338-0965

ABLOY Door Security Solutions Canada
160 Four Valley Drive
Vaughan, Ontario, L4K 4T9 Canada
Tel: 800-461-3007
Fax: 905-738-2478

For a complete listing of products and
applications please visit our web site.
www.nortondoorcontrols.com
www.assaabloy.ca

Norton® and Tri-Style® are registered trademarks of Yale Security Inc., an ASSA ABLOY Group company. Other products' brand names may be trademarks or registered trademarks of their respective owners and are mentioned for reference purposes only. These materials are protected under U.S. copyright laws. All contents current at time of publication. Copyright © 1999, 2012, Yale Security Inc., an ASSA ABLOY Group company. All rights reserved. Reproduction in whole or in part without the express written permission of Yale Security Inc. is prohibited.